

Model: JSMA-PMB10AAK

No.	Item	Symbol	Unit	Specification	No.	Item	Symbol	Unit	Specification
1	Drive	-	-	3φ 220 VAC	13	Rotor Inertia	J-M	kg-cm ²	6.26±10%
2	Cooling Method	-	-	Totally Enclosed	14	Rated Power Rate	Q-R	Kw/s	36.3
3	Exciting Method	-	-	Permanent Magnet	15	Resistance	Ra	Ω	1.22±10%/2φ
4	Resolution	-	-	17 bit ABS	16	Inductance	L	mH	6.7±10%/2φ
5	Rated Output	P-R	KW	1	17	Mech. Time Constant	Tm	ms	1.1±10%
6	Rated Torque	T-R	N-m	4.77	18	Elect. Time Constant	Te	ms	5.49±10%
7	Max. Torque	T-max	N-m	14.31	19	Insulation Class	-	-	Class B
8	Rated Speed	N-R	rpm	2000	20	Operation Temp.	T	°C	0~40
9	Rated Current	I-R	A	5.1	21	Operation Humd.	RH	%	<90
10	Max. Current	I-max	A	15.3	22	Storage Temp.	T	°C	-20°~60°
11	Torque Constant	Kt	N-m/A	1.019±10%	23	Storage Humd.	RH	%	<90
12	Voltage constant	Ke	V/Krpm	61.67±10%/2φ	24	Weight	W	kgw	6.47

PIN	Signal
A	U
B	V
C	W
D	FG

motor wiring

Pm	Signal
B	+5V
I	0V
A	VB+
C	VB-
H	SD+
D	SD-
G	
E	
F	FG

encoder wiring

Note:

- Motor to be IP67.(excluding the shaft opening & connectors)
- The detail of Name plate for Spec. refers to the file DC-JXE-002.



Name Plate for Notice

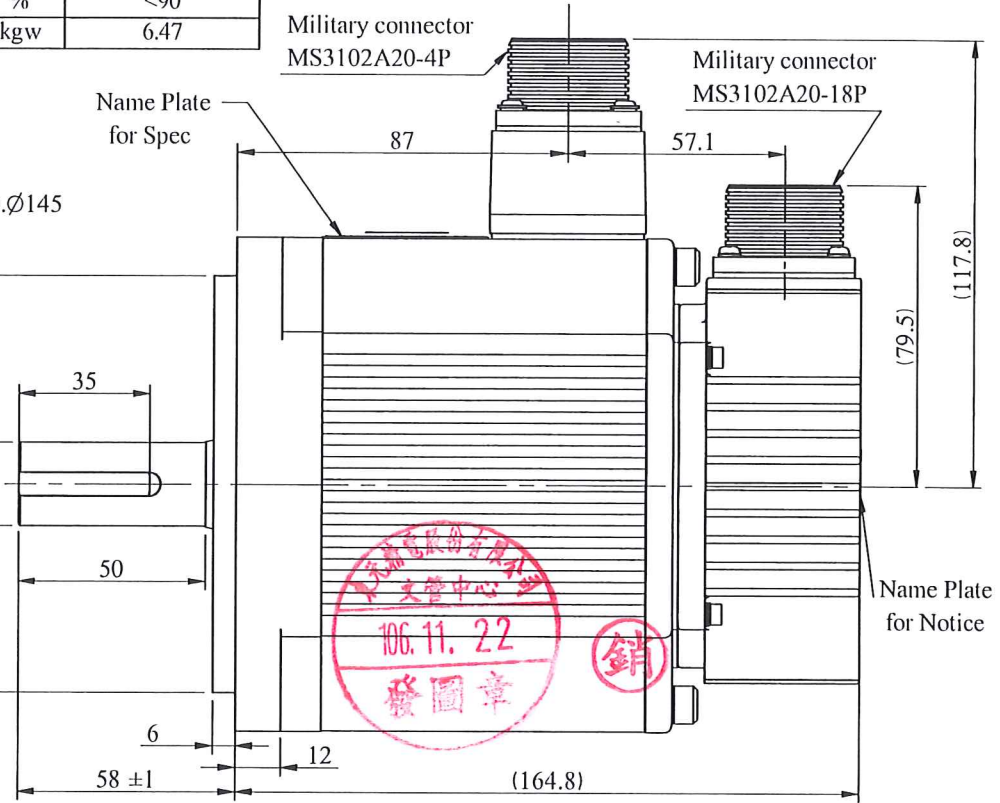
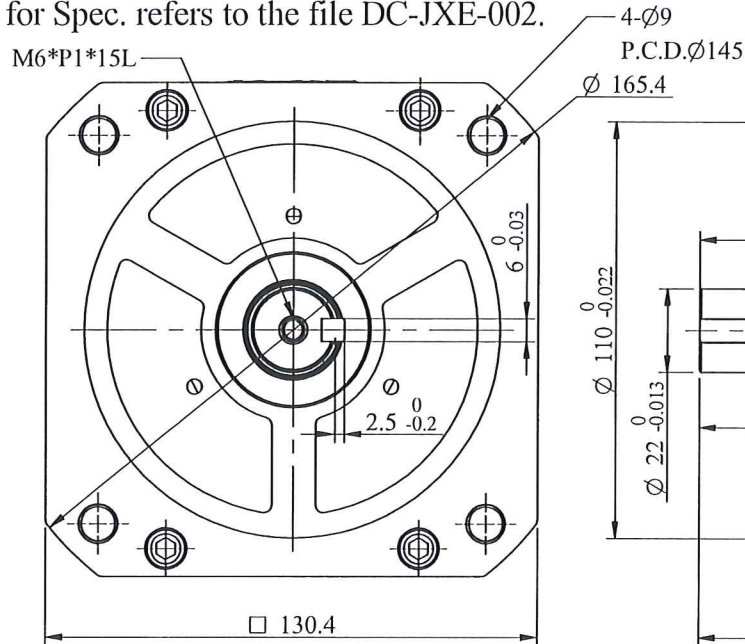

STANDARD TOLERANCE					APVD	<i>Michelle</i>	SCALE	1/2	UNIT	mm	NAME	Servo Motor Outline Drawing	
X	±0.5				CHKD	<i>Michelle</i>	3RD .A.P				TITLE	JSMA-PMB10AAK	
.X	±0.2				CHKD								
.XX	±0.05				DWN	Leon							
ANGLE	±30'				SIGNATURE								
MATERIAL		REV	DESCRIPTION	SIGNATURE	DATE	DATE	TECO ELECTRO DEVICES CO., LTD.		Dept. Design	DWG.NO.	D01B13102B3N3AD01		